

Connect with Anoulack

A community newsletter from Anoulack Chanthivong MP, Member for Macquarie Fields – April 2026



OFFICE: Unit 9 Centennial House, 12 Ingleburn Road, Ingleburn NSW 2565 PHONE: 02 9618 2077 EMAIL: macquariefields@parliament.nsw.gov.au

Green light for safer local roads



With Mayor of Campbelltown Darcy Lound and local residents celebrating the start of works to improve road safety in Minto.

I'm excited to announce that works to install traffic lights at the intersection of Pembroke Road and Durham Street in Minto are currently underway.

The works form part of the NSW Minns Government's \$325 million investment under the Towards Zero Safer Roads Program.



The community has fought long and hard for improved safety measures at this notorious intersection, which sadly was the scene of a fatality late last year.

New traffic signals will be installed at the intersection, including signalised pedestrian crossings. A new median and right-hand turn lane on the eastern approach of Durham Street will also help improve safety. New kerbs, pavement and line markings will all form part of the upgrade of the busy intersection.

The upgrade also means improved safety for the Passfield Park School community, and I look forward to works being completed by the end of June 2026 (weather permitting).

Scan the QR code for more information or contact my office on 9618 2077. ▶



Extra public holiday

Mark it in your calendars!

Monday 27th April is officially a public holiday this year.

The Minns Labor Government has passed legislation to ensure that Anzac Day is appropriately commemorated in NSW, with an **additional public holiday on the Monday following Anzac Day this year and in 2027.**

Anzac Day on 25 April is one of the most important and solemn days on our national calendar, and that will not change.

Adding a public holiday when Anzac Day falls on a weekend will not diminish that tradition. If anything, it is a reminder of its importance and another reason for people to get up, attend a local service and ensure the spirit of remembrance continues to be passed on to the next generation.

INSIDE

New milestone for station upgrade (P2) Cost of Living (P3)
Pembroke Park Upgrade (P4) Local Woman of the Year (P5)

BOB PRENTER RESERVE REDEVELOPMENT

Our local area is now home to one of the best community AFL facilities in Sydney, following a major redevelopment.

I was delighted to join Mayor of Campbelltown Darcy Lound at the official opening of the new facilities at Bob Prenter Reserve in Macquarie Fields in March. This fantastic redevelopment has raised the quality of the facilities to a regional standard.

The project included a new two-storey clubhouse, a new canteen, gym facilities, new changerooms, umpire rooms, improved spectator seating, additional storage and office space.

The project is funded through \$5 million from the NSW Government's Multisport Community Facility Fund, as well as a \$2.8 million contribution from Campbelltown City Council.

It is wonderful to see the NSW Government and Campbelltown City Council working in partnership to deliver contemporary, high-quality, multi-sports facilities that provide opportunities for a range of sporting codes and abilities.

The addition of female-friendly change rooms will ensure this fantastic regional facility will cater for the growing participation of women and girls in local sport, increasing accessibility for everyone in the community.

Investment in local sporting infrastructure plays a critical role in keeping communities healthy, active and connected.

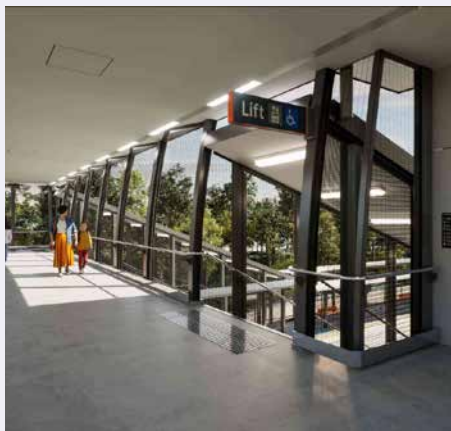

NEW MILESTONE FOR STATION UPGRADE

In an exciting development for the Macquarie Fields Station upgrade project, the lift shafts have now been installed and lifts are set to follow.

This marks a long-awaited and exciting milestone for the project.

The Macquarie Fields Station upgrade is a major win for our community and comes after many years of advocacy. Macquarie Fields residents have fought long and hard for lifts at the station, and I look forward to the project being completed later this year.

The project forms part of the NSW Minns Government Safe Accessible Transport

program which aims to make public transport safe, inclusive and easy to use for all passengers, especially people with disability, older people, people with prams or luggage or others who may be experiencing mobility challenges.

In recent months, works have included opening the new footbridge and stairs, footpath and parking upgrades at the station entrance, progressing with canopy and roof installation on both platforms, fitting out the canopies with ceilings and lighting.

Scan the QR code for project updates or contact my office on 9618 2077. ▶



SMART RENTAL BONDS COMING SOON

Our game-changing program to let you transfer your rental bond will officially launch for NSW's 2.3 million renters in a matter of months.

Smart Rental Bonds will allow tenants to digitally transfer their bond between properties for a small fee of \$25. This means they will no longer have to find thousands of dollars for a "second" bond while waiting for the previous bond to be refunded.

Smart Rental Bonds will deliver on the NSW Minns Government's election commitment to introduce a portable rental bonds system to provide cost-of-living relief for renters and make renting fairer.

The NSW Minns Government is committed to improving the lives of renters, delivering substantial reforms such as ending no-grounds evictions, limiting rent increases to once a year, making it easier to have pets in rentals and introducing a \$8.4 million NSW Rental Taskforce to hold landlords and real estate agents to account.

Scan the QR code to learn more about rental reforms. ▶

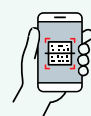

COST OF LIVING



No Interest Loan Scheme

We're extending the No Interest Loan Scheme to help ease the cost of living for low-income households across NSW.

The NSW Minns Government has committed \$21.5 million to fund the Scheme for another five years. The No Interest Loan Scheme helps eligible low-income earners borrow up to \$2,000 for appliances, furniture, car repairs or medical expenses, or up to \$3,000 for housing-related expenses such as rental bonds.

With cost-of-living pressures putting the squeeze on many households, this Scheme helps households who need it most.

▼ Scan the QR code to learn more.



Help with Sydney Water bills

If you need help to pay your water bill, Sydney Water may be able to assist. Support options include payment extensions and plans, Centrelink deductions, pensioner discounts, hardship support and more. For confidential help and advice, contact the Sydney Water customer team on 13 20 92, 8am–5.30pm Monday to Friday (excluding public holidays) and choose option 1, or visit sydneywater.com.au.

Cost of Living Hub

Looking for ways to save?

Visit the NSW Government's Cost of Living Hub, consolidating information in one central place to make it easier to find rebates and vouchers to save you money.

▼ To learn more, scan the QR code.

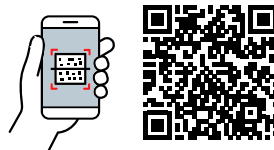

FuelCheck

With fuel prices putting pressure on household budgets, it's more important than ever to shop around.

The NSW FuelCheck app lets you compare petrol prices in real time so you can find the cheapest fuel near you before filling up.

It's a simple tool helping drivers across NSW keep more money in their pockets.

▼ Scan the QR code to learn more.

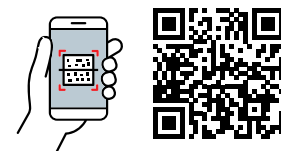

Moneycare

Salvation Army Moneycare Financial Counselling provides free, independent and confidential guidance tailored to your situation.

Moneycare can help with a range of issues such as if you're feeling overwhelmed by rising costs, struggling to pay debts or unable to pay your bills, looking for help with budgeting and having trouble paying your rent or mortgage.

Book in to see a local Financial Counsellor by calling 1800 722 363.

TOLL-FREE M12 OPENED TO TRAFFIC

The NSW Minns Government has cut the ribbon on the new M12 motorway, which opened on 14 March and is toll free.

The 16-kilometre section of the M12 connects Elizabeth Drive in the east to The Northern Road in the west, delivering an intersection-free, 100 km/h run straight to the Western Sydney International (Nancy Bird Walton) Airport precinct.

The new M12 Motorway will take pressure off suburban streets and is expected to take 25,000 vehicles off local roads every day.

The project has been delivered on time and on budget, employing over 10,000 people including almost 5,000 local workers.



TOLL CAP

The NSW Minns Government has now made the \$60 a week toll cap permanent to provide relief to motorists paying the most.

Scan the QR code to claim your rebate.



ENROLMENTS NOW OPEN FOR NEW HIGH SCHOOL

In exciting news for our community, enrolments for Year 7 and Year 8 at Edmondson Park High School are now open.

Families can look forward to sending their children to the brand new local high school, located adjacent to Edmondson Park Public School.

Edmondson Park High School will accommodate up to 800 students and include fit-for-purpose classrooms and core facilities to meet enrolment demand.

Fit out is currently underway, including installation of furniture and fixtures. External works and landscaping are progressing.

It's fantastic to see the school taking shape after a long community campaign.

The project is on track for Day 1, Term 1 2027.

Scan the QR code to learn more about the project, including enrolments details. ▶

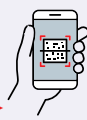

At the site of the new high school for Edmondson Park in September 2025. ▶



PEMBROKE PARK UPGRADE

I was delighted to join Mayor of Campbelltown Darcy Lound in March to officially open the new playground at Pembroke Park in Minto.

The \$480,000 project replaced the existing play equipment with contemporary new equipment as well as upgrades to the surrounding park's amenity.

The project is supported by an \$80,000 contribution from the NSW Government's Community Building Partnership grants program, and includes a new flying fox, shade sail and outdoor fitness equipment.

The Pembroke Park upgrade means more local families can enjoy this vital open space for connection and recreational opportunities.



OUT AND ABOUT

It was another glorious Ingleburn Alive festival. Celebrated on 14 March, it was a great day out for families and a wonderful opportunity to showcase our local community spirit.

I was joined by Anne Stanley MP and David Moncrieff MP for the festivities.



PUBLIC PRESCHOOLS FOR LOCAL KIDS

The NSW Minns Government is investing \$769 million to deliver 100 new public preschools, co-located with public primary schools in NSW. This is the largest investment in public preschools in NSW history, helping more children access a high-quality preschool program before starting school.



Curran Public Preschool

Construction works are well underway on a new public preschool at Curran Public School. The preschool will accommodate up to 40 children per day and will include two preschool rooms, an outside play area, administration area, amenities, staff kitchen and storage.

The concrete slab foundation has been poured, steel wall frames are in place, and roofing works are progressing.

The next stage involves installing windows, doors and external walls. This will be followed by the installation of internal linings, flooring and fittings, and landscaping works.

Scan the QR code for more information. ▶



Sackville Street Public Preschool

Works are well underway on a new public preschool at Sackville Street Public School. The concrete slab foundation has been poured, steel wall frames are in place, and roofing works are progressing.

The preschool will accommodate up to 60 children per day and will include three preschool rooms, an outside play area, administration area, amenities, staff kitchen and storage.

The next stage involves installing windows, doors and external walls. This will be followed by the installation of internal linings, flooring and fittings, and landscaping works.

Scan the QR code for more information. ▶



**Want to keep up to date on school projects in your local area?
Scan the QR code to sign up for updates.**



Local Woman of the Year

Congratulations to 2026 Local Woman of the Year, Jennifer Watt, on being recognised for her generous contributions to our local community.

Jenny has dedicated more than 40 years to volunteering, most notably as a coordinator of the Ingleburn Knitting Group. Over the years, Jenny has raised \$14,000 through Cancer Council's Biggest Morning Tea fundraisers, volunteered on school committees and supported local Girl Guides.

I was delighted to present Jenny with her award and recognise her long-standing volunteering efforts and valuable contributions to our community.

Scan the QR code to read my speech in NSW Parliament. ▶



Chat with Anoulack...

With ... Philip Durbridge



Bardia's Philip Durbridge is a volunteer with Myrtle Cottage and thoroughly enjoys the interactions he has with its members, which includes people over 65 years of age and people with disability. The Cottage is due to celebrate 20 years at its current location in July, and 50 years of serving the local community in 2027.

HOW DID YOU GET INVOLVED WITH MYRTLE COTTAGE?

I moved to Bardia 14 years ago, and post-Covid I was looking for local volunteer opportunities. Myrtle Cottage in Ingleburn is close to home. Since starting with the Cottage in 2022, I haven't looked back. I love it!

TELL US MORE ABOUT MYRTLE COTTAGE.

Myrtle Cottage is a community-based organisation, providing activities for people who are 65 years plus, frail aged, younger people with disabilities and respite care for people with dementia. From the time Myrtle Cottage commenced in November 1977 to July 2006, the Cottage operated in the Ingleburn Community Health building. Following the development of the new site at Bosci Road in Ingleburn, Myrtle Cottage moved to the purpose-built facility in July 2006. Myrtle Cottage has since expanded, with a new facility now open in Spring Farm.

DESCRIBE A TYPICAL DAY AT THE COTTAGE.

I usually volunteer two days per week at the Cottage. The day commences at 8.30am with the buses leaving the Cottage to pick

up the members from their homes. I am licensed to drive the smaller buses. We pick members up from throughout Macarthur. I have a bus assistant with me on my runs, who helps people in wheelchairs and takes good care of the members.

Once we're back at the Cottage, it's time for morning tea. After the morning activity, lunch is served at 12.30pm and afternoon activities commence at around 1.15pm. A lot of planning goes into a day at Myrtle Cottage, which promotes social connection. For some members, a day at Myrtle Cottage might be the only outing in a week. Many of our members are housebound and lonely. At 2.30pm, we say goodbye to the members, load the buses and take members home. All the buses are back at the Cottage by 4pm.

WHAT ARE SOME OF THE PROGRAMS ON OFFER AT THE COTTAGE?

The Social Connection Group offers activities in consultation with members, and the program varies daily. An activity program is distributed every six weeks and includes craft, small interest groups, games, quizzes, guest speakers and outings. The program operates Monday to Friday. Some recent outings include to the Darrell

Lea factory in Ingleburn (don't forget my favourite rocky road), and visits to Greater Sydney Parklands, The Australian Botanic Garden Mount Annan and Liverpool Museum.

WHAT DOES VOLUNTEERING MEAN TO YOU?

Volunteering at Myrtle Cottage brings me a great deal of satisfaction. I enjoy engaging with the members and the dedicated staff to help others and bring a touch of 'home away from home.'

It's a great feeling to know you're making a small difference in someone else's life. Seeing the smiles on people's faces and sharing some laughs is wonderful. Myrtle Cottage is like a big family to me.

My wife, Ann, also volunteers at Myrtle Cottage and has hosted candle making workshops.

WHAT IS SOMETHING THAT PEOPLE DON'T KNOW ABOUT YOU?

I dress up as 'The Grinch' for Myrtle Cottage's Christmas party. It's a big celebration and I love preparing for the festivities.

HOW CAN PEOPLE VOLUNTEER WITH MYRTLE COTTAGE?

Anyone interested in volunteering with Myrtle Cottage can call 9426 3100 or email info@myrtlecottage.org.au. There is always a need for volunteers, especially bus drivers with LR licence. It's a wonderful opportunity to help others.

Scan the QR code to learn more. ▶

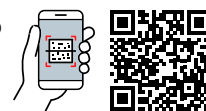

CONTACT ANOULACK

If you have any ideas, comments or suggestions, or wish to discuss State Government matters, please drop into the office or contact me on:

📍 Unit 9 Centennial House, 12 Ingleburn Road, Ingleburn NSW 2565 ☎ 02 9618 2077

✉ macquariefields@parliament.nsw.gov.au 🌐 connectwithanoulack.com

Labor

